

UMSL All Staff Meeting

Thursday, September 21, 2023

2:30 – 4:00 PM





University of
Missouri–St. Louis

Welcome from Chancellor Sobolik

Meeting Agenda

- Welcome from Staff Council/updates
- UMSL Serves update from Dr. Patricia Zahn
- UMSL PD update from Chief Freet
- Transform UMSL/Facilities update from Blake Sutter
- Meeting Wrap-up



Meet Your Staff Council

2023-2025

Britne Bacca-Haupt (Chair)

bbacca@umsl.edu

Lauren Bledsoe

Mary Bosnick

Cleola Butler

Yuan Chen

Mindy Dilley (Vice Chair)

dilleym@umsl.edu

Bob Ell

Becky Flores

Katie Fraizer

Adrienne Groves (Secretary/Treasurer)

grovesa@umsl.edu

Trinity James

Keri Jupka

Stephanie Kaimann

Shereka Kemp

Jenny Martin

Blain McVey

Megan Miller

Kevin Mitchell

Aaron Poelker

David Stofer

Mindy Stratmann-Sebol

Rachel Thompson

Melissa Travers

David Woods

J Woods

Olivia Mendez-Alm (past Chair)



University of
Missouri–St. Louis



University Assembly Committees

Staff Council Representatives

University Assembly (Britne Bacca-Haupt, Cleola Butler, & Blain McVey)

Budget & Planning (Britne Bacca-Haupt & Keri Jupka)

Physical Facilities, Space & General Services (Bob Ell)

Student Affairs (David Woods)

Administrator Evaluation (Megan Miller)

Information Technology (Jenny Martin & David Stofer)

Recruitment, Admissions, Retention & Student Financial Aid [RARSFA]

(Rachel Thompson & Katie Fraizer)

Ways to Attend Meetings

- **University Assembly Meetings**

- September 26th, November 14th, February 20th, and April 30th
- 3:00 PM
- The meetings will be held in MSC Century Room A. If a Zoom option is needed, email senate@umsl.edu for the Zoom link.
- <https://www.umsl.edu/committees/senate/senate-meetings-action/2023-2024-meeting-dates.html>

- **Budget & Planning Meeting**

- Only one scheduled so far is Monday, September 25th at 10:00 AM. If you want the Zoom link, email senate@umsl.edu

- **Staff Council Meetings**

- On the 3rd Thursday of the month; 10:00 – 11:30 AM
- Hybrid – ABH 103 & Zoom; email staffassoc@umsl.edu for Zoom link



University of
Missouri–St. Louis



3D DIGITAL MOBILE MAMMOGRAPHY SERVICES WILL BE AT

UMSL

#1 UNIVERSITY BLVD.
ST. LOUIS, MO 63121

NOVEMBER 29, 2023

8:45 a.m. – 2:00 p.m.

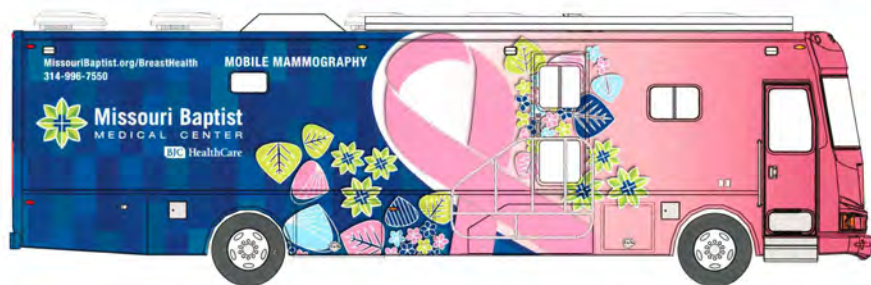

Please check with your medical insurance provider to verify your benefits and eligibility.
Bring your insurance card, your physician's name/phone number, and a form of identification with you to your appointment.

Call **314-996-5170**
today to schedule
your appointment!



Missouri Baptist
MEDICAL CENTER
BMC HealthCare





What: A sock drive to support our STL community this winter

When: The month of October

Where: Drop boxes located across campus

UMSL 60th Service

Celebrating UMSL's 60th Anniversary with 60,000 Hours of Service!

Join the Movement: #UMSLserves

In honor of UMSL's 60th birthday, we're embarking on an extraordinary journey to complete 60,000 community service hours! It's a remarkable way to commemorate our university's rich history and make a lasting impact on the communities we call home.

Who Can Participate?

Absolutely everyone who shares a love for UMSL is eligible to join us on this meaningful journey. Your background, identity, or affiliation don't matter—what counts is your desire to give back to your community.





UMSL 60th Service

[Discover More](#)

Visit our dedicated webpage to access a media kit for creating compelling social media content, promoting the cause during Zoom meetings, and enhancing your presentations with impactful visuals. Include #UMSL60 and #UMSLServes in your posts.

[Get Involved Today!](#)

Gather your friends, colleagues, or fellow students and volunteer as an organization of your choice. You can also explore volunteering opportunities through the United Way website.

[Log Your Hours](#)

Don't forget to track your service hours and contributions by logging them on our UMSL 60th Volunteer page.

Together, let's make UMSL's 60th anniversary an occasion to remember, leaving a legacy of compassion, unity, and service in our wake.

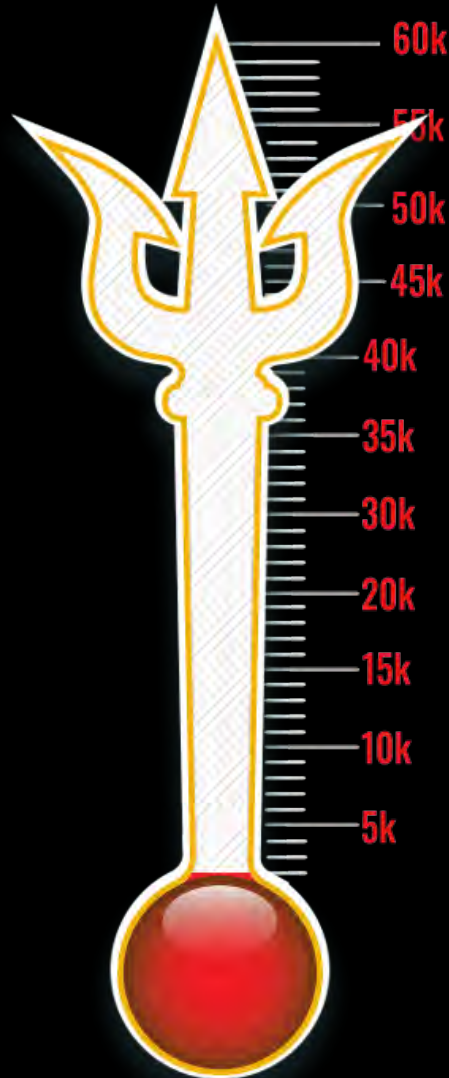

UMSL Month of Community Giving

UMSL's Commitment to Giving Back

Collaboration: This campaign supports over 250 nonprofit organizations.

Investment: We're committed to investing in our community's well-being.

Generosity: Join us in making a difference through our service and giving initiatives.

Learn More: [UMSL Month of Community Giving](#)





UMSL POLICE UPDATE

CHIEF DAN FREET

AUGUST 2023



➤ UMSL PD Overview

➤ Community Policing Philosophy

- Emphasis on problem solving

- Transparency-includes body worn cameras

➤ All officers Crisis Intervention Team Members

➤ Work closely with surrounding agencies

➤ Train regionally with other PDs (MacTac)

➤ PD oversees Parking and Shuttles

➤ PD includes Emergency Management planning

- 
- **UMSL PD Services**
 - **24/7 Preventive Patrol**
 - 5258 Foot Patrols YTD
 - 5104 Vehicle Patrols YTD
 - **Narcan and AED equipped**
 - **Safety Escorts (85 YTD)**
 - **Motorist Assist**
 - **Monthly Blue Phone Tests**



- **UMSL PD Services**

- Security Audits

- Securing Buildings/Building Access

- Emergency Orders of Protection

- RAVE Guardian mobile safety app

- Training for campus affiliates

- Active Shooter Response Training

- Self Defense

- Crime Prevention

[Apply Now >](#)

[Request Info >](#)

[Give >](#)



Rave Guardian Safety App



➤ Campus and Community Affiliations

- UMSL CARE Team
- Title IX
- Campus Clery Coordinator
- Student Affairs/Health Wellness and Disability Access
- Succeed Program
- UMSL Anchor Institution Initiative
- Tritons United (Dept. of Justice Domestic Violence Grant)
- Partners in Prevention

- 
- **UMSL PD Incidents YTD 2023**
 - 1,977 calls for service
 - **Most Frequent Calls for Service:**
 - Sick Case
 - Found Property
 - Theft
 - Auto Accident
 - Check Welfare
 - Suspicious Person

**UMSL Five-Year Total NIBRS (Formerly Uniform Crime Reporting-UCR)
Offense Report
Part I Crimes**

Year	Homicide	Manslaughter	Rape	Attempt Rape	Robbery	Aggravate d Assault	Burglary	Larceny	Auto Theft	Arson	Violent Crimes	Property Crimes
2018	0	0	1	0	1	0	9	57	0	0	2	66
2019	0	0	0	0	0	1	9	51	0	0	1	60
2020	0	0	1*	0	0	1	7	26	0	0	2	33
2021	0	0	0	0	0	0	0	14	0	0	0	14
2022	0	0	0	0	0	0	2	15	4	1	0	22



2023 Jan-Aug UMSL Crime by Location

- Buildings (non-residential) 36%
- Parking Areas 36%
- Residential 14%
- Other/Unknown/Internet 14%



RECOMMENDATIONS:

- Download RAVE Guardian app on your cell phone
- Encourage evening staff/students to walk with others or call for safety escort
- Secure personal items while on campus
- “See Something Say Something”

UMSL

We transform
LIVES

UNIVERSITY OF MISSOURI-ST. LOUIS

Leadership Meeting

UMSL Facilities
September 2023

Scope

- Build out shell space on the 2nd floor of the Patient Care Center (PCC) for the College of Optometry. The remainder of coursework outside of the PCC will be conducted in Provincial House

Key Highlights

- Project substantially complete



Richter Family Welcome & Alumni Center

Scope

- Renovate the J.C. Penney South Building into a state-of-the-art Welcome & Alumni Center to enhance the campus experience for prospective students and visiting alumni
- Construct exciting community spaces, meeting rooms, and offices to support the UMSL Admissions, Alumni Engagement, and New Student Programs groups

Key Highlights

- Demolition in progress
- Currently construction phase out to bid
- Construction starts Q4 2023



TJ and Mercantile Library Renovation

Scope

- Renovate Thomas Jefferson and Mercantile libraries. Includes new student-focused spaces on the main level, a new café area, and an additional entrance on the north side of the library to improve connection with the North Campus Quad
- Relocate existing SSB computer lab to TJ Library
- Relocate library staff to a new administrative suite on the 5th floor
- Project will include an art gallery space in the Mercantile library

Key Highlights

- Final adjustments to engineering design in progress
- Construction anticipated to start Fall 2023



SSB Modernization & Expansion

Scope

- Renovate Social Sciences & Business Building (SSB). Scope includes interior renovations, improvements to building infrastructure, and a new elevator
- Relocate the College of Education and Honors College program from South Campus to the North Campus Quad

Phase 1 - Build new elevator for SSB

Phase 2 - Demolish SSB Tower

Phase 3 - Renovate SSB and construct new SSB Expansion

Key Highlights

- Phase 1: SSB Elevator construction will start this week
- Phase 2: SSB Tower demolition will start in Spring 2024
- Phase 3: SSB Modernization & Expansion schematic design in progress



Scope

- Relocating the College of Optometry from Marillac Hall to the J.C. Penney North Building. This would include renovations to provide faculty and staff offices, classrooms, study and breakout rooms, labs, and research space

Key Highlights

- JCP North schematic design in progress
- Exploring south campus dining options



Scope

- Consolidate music and fine arts to the Arts & Administration Building on the North Campus. Includes interior renovation and infrastructure improvements to AAB
- Once AAB renovations are complete, the Music Building will be demolished as a separate project
- The Sculpture and Ceramics Annex is not in the scope of this project

Key Highlights

- Bid in progress for selective demolition and data closet relocation
- Design development for the remaining design is in progress and will complete by end of year
- Construction scheduled to start Spring 2024



Central Utility Plant – North Campus

Scope

- UMSL is partnering with a highly capable engineering firm to complete a study/concept design for a central utility plant located on the North Campus
- Goals of this project:
 - Sustainability
 - Improved efficiency of building systems
 - Reduced operating and maintenance costs
 - Replace end-of-life equipment
 - Introduce a geothermal system to UMSL's campus

Key Highlights

- Study phase 70% complete
- Building utility metering in progress

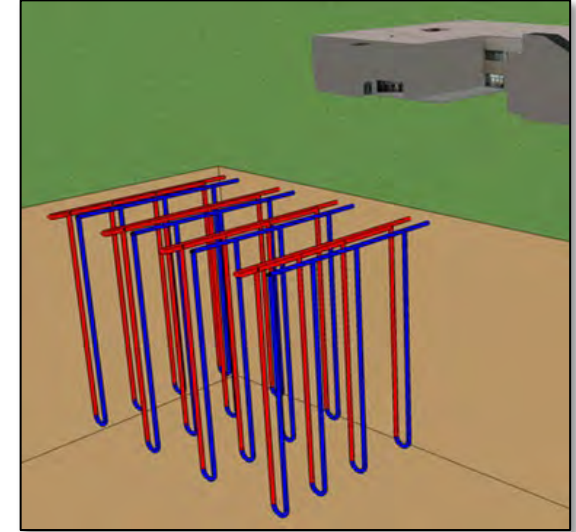

Demo Buildings

Scope

- Selective demolition of buildings on UMSL's Campus in alignment with the 2021 Campus Master Plan and the overall vision of UMSL's physical campus
- Removes millions in deferred maintenance to improve UMSL's operating costs
- Approximately 232,000 sqft will be demolished as part of the campus consolidation

Key Highlights

- Sassin Building & Post Office demolition complete
- SSB Tower demo will start Spring 2024



ARPA Program Schedule

KEY

- | Current Date
- ◇ Construction Start
- ▲ Go Live
- ◇ Early Construction Package

Optometry to PCC ✓

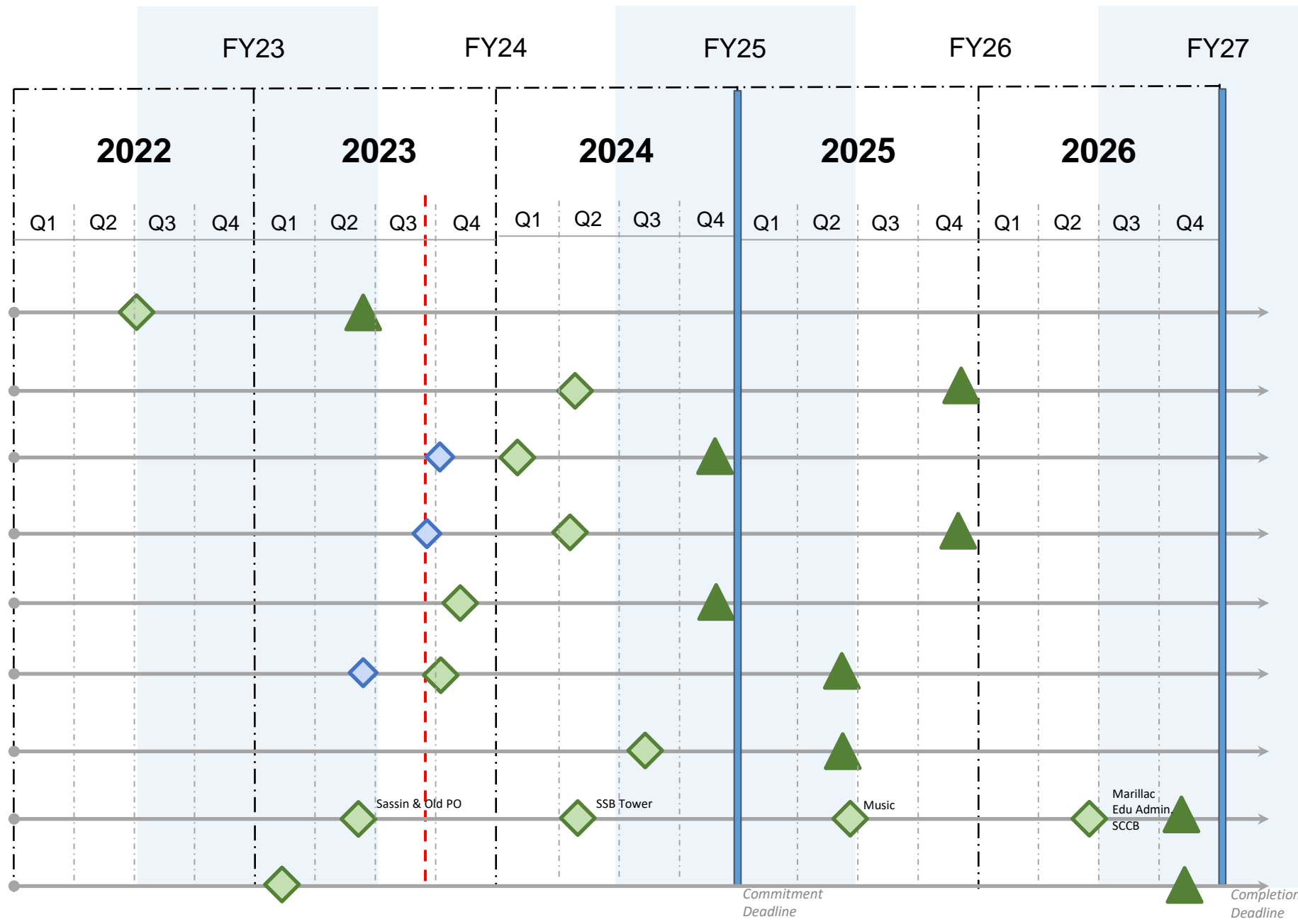

Commitment Deadline

Completion Deadline

Sassin & Old PO

SSB Tower

Music

Marillac Edu Admin SCCB

Remaining All Staff Dates

- **November 9th: 2:30 – 4:00 PM**
 - Hybrid – MSC Chamber (3rd floor) & Zoom
- **February 8th: 2:30 – 4:00 PM**
 - Zoom Only
- **April 11th: 2:30 – 4:00 PM**
 - Hybrid – MSC Chamber (3rd floor) & Zoom
- iCal links (with Zoom links) were sent from the Staff Association email; please email staffassoc@umsl.edu if you would like them resent





We want your input!

We want to hear from you about future All Staff Meeting topics and speakers as well as staff interest groups. Please fill out the survey!

<https://tinyurl.com/umslstaff>





A large red graphic featuring a stylized '6' and the University of Missouri-St. Louis logo. The '6' is a thick, red, sans-serif numeral. Inside the bottom curve of the '6' is a white circle containing the text '1963' over a horizontal line, followed by '2023'. To the right of the '6' is a circular logo with a red background and a yellow and white stylized 'M' that resembles a flame or a leaf. Below the logo, the text 'UNIVERSITY OF MISSOURI-ST. LOUIS' is written in a red, sans-serif font, following the curve of the bottom of the logo.

Thank you! We appreciate all that you do for UMSL & our Students!